



Rowan Wood School Facilities

EXCELLENCE, AMBITION & EXPERTISE



AMBITION



CONTRACTORS



Galliford Try

Galliford Try Construction have been appointed by the Royal Borough of Greenwich to deliver Rowan Wood School. They are on of the leading contractors in the country across schools, colleges and universities.

Over the last three years, Galliford Try Contractors have been involved in delivering 17 projects to deliver special school provision. Their projects have previously covered a wide spectrum of needs from social, emotional and mental health needs, to moderate learning difficulties, and up to complex needs including respite and residential care. As such, they understand the importance of creating tailored facilities to meet the needs of children and young people with SEND.



LOCATION



Rowan Wood School

The secondary and sixth form campus (years 7 to 14) is to be built at Hargood Road, SE3 8HR, on the former site of Kidbrooke Park Primary School. A purpose built, new build will be created on the site. The primary campus (Reception to Year 6) will be developed on an alternative site within the borough. Its location is to be confirmed.



FACILITIES



Rowan Wood School

Rowan Wood School will provide purpose-built, state of the art facilities to cater for the needs of the children and young people attending.

This includes:

- Suspended equipment room for sensory processing work
- Large, multi-function hall
- A dedicated dining hall
- Forest schools area
- 2 sensory rooms, fulfilling different functions
- Sensory circuit room
- Multi use games area (MUGA)
- Food technology room
- Libraries
- A dedicated sixth-form area which includes a common room, kitchen & life skills room
- Therapy spaces
- Specialist music room
- Specialist room for teaching science
- Generous outdoor spaces
- Dedicated teaching spaces to cater for all ages
- 61 parking spaces, including charging facilities for electric vehicles



FACILITIES



Artist impression of secondary & sixth form campus.



FLOORPLAN

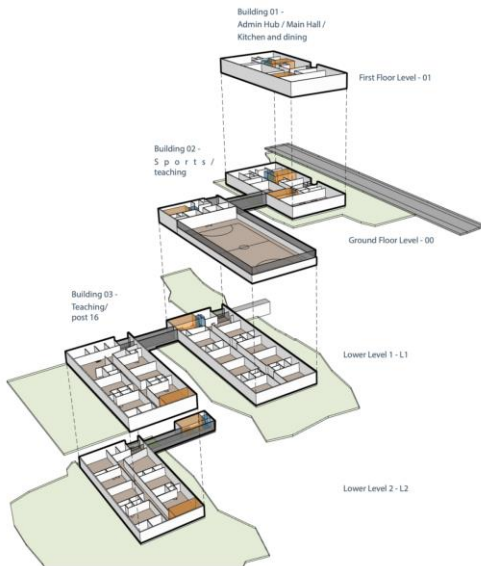

This image shows an 'exploded' floorplan of the secondary & sixth form campus, demonstrating how each of the three buildings will connect with each other.





EXCELLENCE, AMBITION &
EXPERTISE

