



Statutory Consultation Information Event: Rowan Wood School

EXCELLENCE, AMBITION & EXPERTISE



AMBITION

EXCELLENCE



EXPERTISE



S10 CONSULTATION



Why consult?

- Legal requirement under Section 10 of the Academies Act (2010) to hold a consultation exercise to determine whether the Trust should enter into a Funding Agreement with the Secretary of State
- Seek honest and open engagement with stakeholders in the community and beyond
- Provide a mechanism for stakeholder and wider community views and feedback to be heard

Consultation running over a six-week period from 16 September 2024 to 28 October 2024



THE TRUST

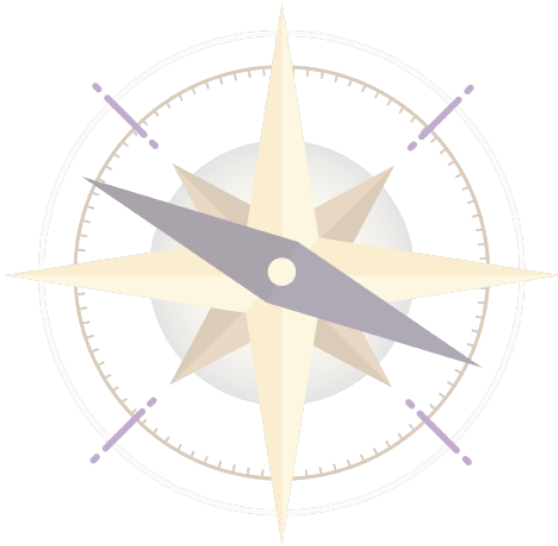

COMPASS

- A thriving, successful and ambitious civic trust, anchored in Greenwich and an integral part of the local ecosystem
- Highly inclusive and a Trust recognized for excellence – top 10% of Trusts nationally for KS2
- A capacity giver and system leader
- Highly motivated, developed and professional staff team – very low turn-over
- Strong, high quality central services
- Community engaged – parents integral to drive and development of the Trust – Parent Forum, Local School Committees



THE TRUST



OUR DNA

- Strong values – children and families at the centre of delivery
- High quality curriculum and pedagogy across all academies
- Collaboration for professional development and school improvement
- Ambition for all underpinning a strong track record of school improvement
- Highly skilled and effective governance at all levels focused on a great school at the heart of every community
- Strong financial management – highly effective use of resources
- Effective estates management and impactful use of CIF and SCA to improve all school buildings
- Committed to the whole system, give to and learning from others
- Consistent and compelling record of impact across all settings



THE TRUST



Vision 2030

Compass' special schools are central to the Trust Strategic Plan:

- To ensure a great school thrives at the heart of a thriving community providing a broad range of services to families, communities and wider stakeholders
- A Trust that is a strong recognised partner and influencer in the system with a compelling offer for children, staff, families, schools and other Trusts
- A Trust that significantly narrows the gap for children who have been disadvantaged and provides a high-quality education for children with SEND in both Special and Maintained sectors



THE TRUST



WILLOW DENE
SCHOOL



November 2022



Autism Accredited Setting
Advanced Status
July 2021



Quality Assurance Reviews
Leading Status
2019-Current



December 2022

Practice Illustrated by Case Studies



THE TRUST



ROWAN WOOD SCHOOL



THE TRUST



ALDERWOOD
PRIMARY SCHOOL



BOXGROVE
PRIMARY SCHOOL



CANN HALL
PRIMARY SCHOOL



DEANSFIELD
PRIMARY SCHOOL



HALSTOW
PRIMARY SCHOOL



HORN PARK
PRIMARY SCHOOL



JOHN RAY
JUNIOR SCHOOL



KIDBROOKE PARK
PRIMARY SCHOOL



NOTLEY GREEN
PRIMARY SCHOOL



ROWAN WOOD
SCHOOL



SHALFORD
PRIMARY SCHOOL



SOUTH RISE
PRIMARY SCHOOL



WILLOW DENE
SCHOOL



WINGFIELD
PRIMARY SCHOOL



THE VISION

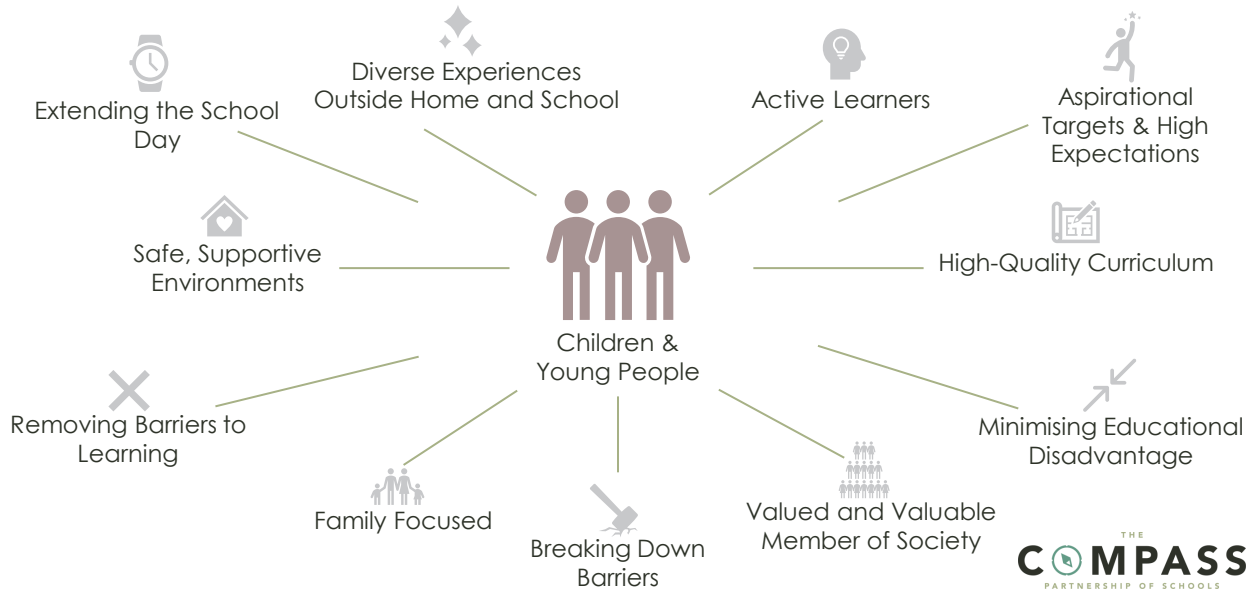

CURRICULUM



CHILD AND INDEPENDENCE AT THE CORE

ESTABLISHED MODELS ACROSS ALL PHASES (EYFS – KS5)

EMPHASIS ON AUTISM-SPECIFIC NEEDS

MODELS ARE APPROPRIATE FOR ALL LEARNING PROFILES

ESSENTIAL STRANDS MEET HOLISTIC NEEDS

CAREFULLY SELECTED PEDAGOGICAL APPROACHES

PREPARATION FOR NEXT STAGE AND FUTURE

MICRO AND MACRO TRANSITIONS CAREFULLY PLANNED

STRUCTURE AND ROUTINES INTEGRAL

SENSORY REGULATION EMBEDDED

IMPORTANCE OF PLAY AND DEVELOPING INTERESTS



CURRICULUM



CHILD AND INDEPENDENCE AT THE CORE

ESTABLISHED MODELS ACROSS ALL PHASES (EYFS – KS5)

EMPHASIS ON AUTISM-SPECIFIC NEEDS

MODELS ARE APPROPRIATE FOR ALL LEARNING PROFILES

ESSENTIAL STRANDS MEET HOLISTIC NEEDS

CAREFULLY SELECTED PEDAGOGICAL APPROACHES

PREPARATION FOR NEXT STAGE AND FUTURE

MICRO AND MACRO TRANSITIONS CAREFULLY PLANNED

STRUCTURE AND ROUTINES INTEGRAL

SENSORY REGULATION EMBEDDED

IMPORTANCE OF PLAY AND DEVELOPING INTERESTS



THE
COMPASS
PARTNERSHIP OF SCHOOLS

MEASURING SUCCESS



OUR KPIS:

- All CYP make good or outstanding progress
- All provision and practice is good or outstanding
- All CYP to engage in reading for pleasure
- CYP from vulnerable groups to make good or outstanding progress
- All achievement will be recognised and celebrated
- Attendance will be higher than national average for similar provision
- There is a holistic approach to behaviour
- 0% NEET on leaving
- Staff satisfaction and retention high
- CYP and parent voice will be strong



THE
COMPASS
PARTNERSHIP OF SCHOOLS

CONTRACTORS



Galliford Try

Galliford Try Construction have been appointed by the Royal Borough of Greenwich to deliver Rowan Wood School. They are one of the leading contractors in the country across schools, colleges and universities.

Over the last three years, Galliford Try Contractors have been involved in delivering 17 projects to deliver special school provision. Their projects have previously covered a wide spectrum of needs from social, emotional and mental health needs, to moderate learning difficulties, and up to complex needs including respite and residential care. As such, they understand the importance of creating tailored facilities to meet the needs of children and young people with SEND.



LOCATION



Rowan Wood School

The secondary and sixth form campus (years 7 to 14) is to be built at Hargood Road, SE3 8HR, on the former site of Kidbrooke Park Primary School. A purpose built, new build will be created on the site. The primary campus (Reception to Year 6) will be developed on an alternative site within the borough. Its location is to be confirmed.



FACILITIES



Rowan Wood School

Rowan Wood School will provide purpose-built, state of the art facilities to cater for the needs of the children and young people attending.

This includes:

- Suspended equipment room for sensory processing work
 - Large, multi-function hall
 - A dedicated dining hall
 - Forest schools area
 - 2 sensory rooms, fulfilling different functions
 - Sensory circuit room
 - Multi use games area (MUGA)
 - Food technology room
- Libraries
 - A dedicated sixth-form area which includes a common room, kitchen & life skills room
 - Therapy spaces
 - Specialist music room
 - Specialist room for teaching science
 - Generous outdoor spaces
 - Dedicated teaching spaces to cater for all ages
 - 61 parking spaces, including charging facilities for electric vehicles

THE
COMPASS
PARTNERSHIP OF SCHOOLS

FACILITIES



Artist impression of secondary & sixth form campus.

THE
COMPASS
PARTNERSHIP OF SCHOOLS

FLOORPLAN

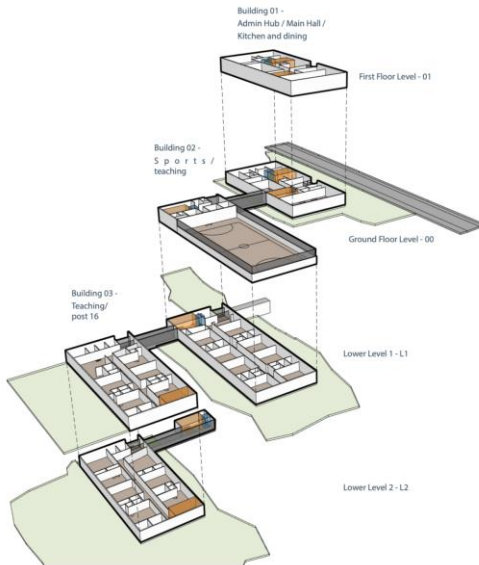

This image shows an 'exploded' floorplan of the secondary & sixth form campus, demonstrating how each of the three buildings will connect with each other.



ADMISSIONS



- Rowan Wood School is a special free school which will provide 240 places for children and young people aged 4-19 who have been diagnosed with autism and severe language and learning delays, working significantly below age-related expectations.
- The Compass Partnership of Schools is not the admitting authority. Children and young people are placed in our school by the Local Authority through the EHCP process.
- For a child to be admitted, the school must be named, by a local authority, in the child's education health and care plan ('EHCP').
- Parents/carers wishing their children to benefit from our provision should ask their local authority to contact Royal Borough of Greenwich SEND Assessment and Review Team.
- Children may currently be in a SEND placement, or they may be in a mainstream placement with SEND support. The process is the same regardless of the current placement.
- For further information on our school, and the process for obtaining a place at Rowan Wood please contact Special Needs at Royal Borough of Greenwich special-needs@royalgreenwich.gov.uk
- Our statement of provision and admissions policy is available via the consultation website <https://www.compassps.uk/rowanwoodconsultation>



TRANSPORT



- RBG has a duty to make particular travel arrangements for any child or young person who cannot reasonably be expected to walk to school because of their mobility problems or because of associated health and safety issues related to their special educational needs (SEN) or disability, in order to facilitate their attendance at an appropriate education provision.
- RBG will assess the eligibility on an individual basis to identify particular transport requirements.
- All children and young people transitioning from year 6 to year 7 will need re-apply for transport, regardless of their onward destination.
- Rowan Wood School will have access to school minibuses to help facilitate transport
- Some young people in sixth form will complete independent travel training in year 13
- Further information from the Royal Borough of Greenwich regarding school transport can be found [here](#)



PROGRESS



- Rowan Wood Strategic Board Group and the Rowan Wood Project Development Group have been established
- Building contractor for the build has been agreed
- Recruitment process for headteacher designate has started
- Secondary & sixth form campus site and planning permission has been granted by Royal Borough of Greenwich
- Trust has agreed the plans for the new school
- Admissions policy has been agreed between the Trust and Royal Borough of Greenwich
- Work on the proposed logo for Rowan Wood School has started
- Interim pre-opening governance arrangements have been established
- Rowan Wood School curriculum is in development, drawing on the Compass special schools' curriculum
- Admissions panel date for October 2024 has been set
- Secondary & sixth form campus site progress visits are taking place
- Trust is networking with other special free schools to share good practice





FEEDBACK



Consultation period:

- From 16 September 2024 to 28 October 2024

Ways to provide your feedback:

- Our online questionnaire
- By writing to us: New School Consultation, C/O Willow Dene School, Swingate Lane, Plumstead, London, SE18 2JD
- By emailing us at rowanwoodconsultation@compassps.co.uk



EXCELLENCE, AMBITION &
EXPERTISE

